

1" BLACK SHELRRESIN TOP

(FINISH ALL TOP ENDS)

11'-2 3/4"

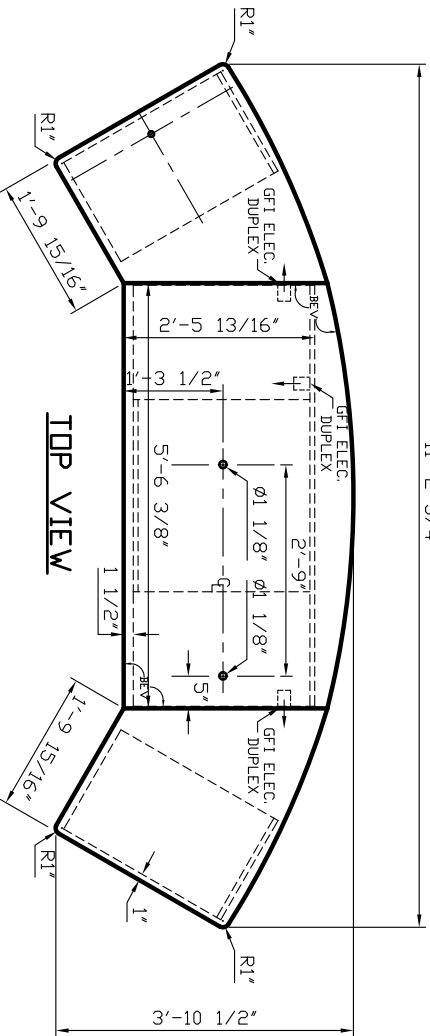

TOP VIEW

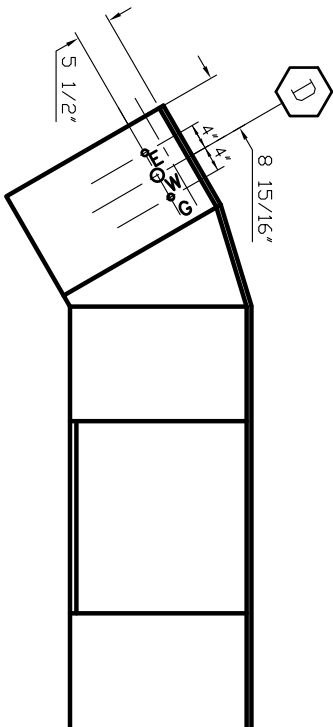

SUGGESTED ROUGH-IN

- SERVICES:**
- (1) L4200-131WS SINGLE BALL VALVE FIXTURE
 - (5) 85101 GFI ELEC. DUPLEX OUTLET AND COVER PLATE.

- UPRIGHT ROD ASSEMBLY:**
- (2) 86300 (36") UPRIGHT ROD.
 - (1) 86370 (42") CROSSBAR.
 - (2) 86340 ROD CONNECTOR.
 - (2) 86320 ROD BASES.

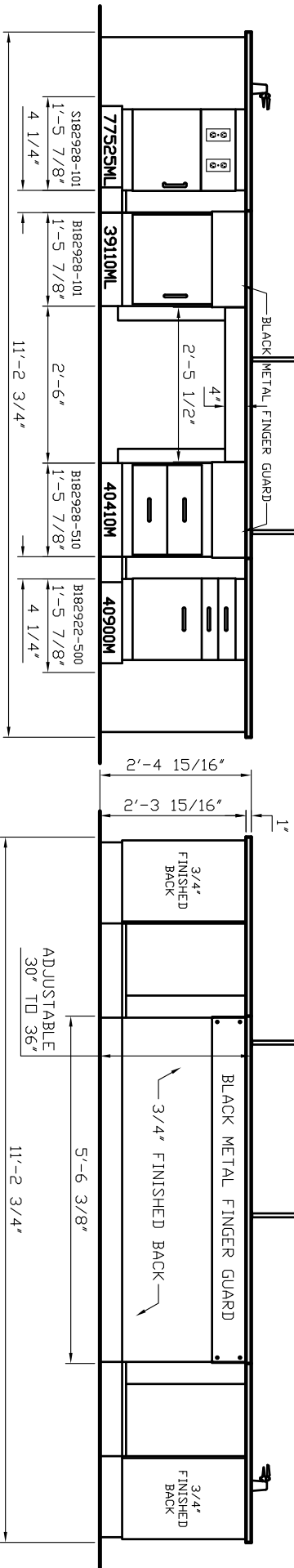

ELEVATION 4 LEVEL 1 (1) REQUIRED

BACK VIEW

Sheldon
Laboratory Systems

Front Office Box 636
20000 Sheldon Street, MS 30009
Farmingdale, NY 11735-2231
Telephone: (516) 882-2331
Fax: (516) 882-2344

A LESCO Company

JOB NAME

BLUE HILLS TECHNICAL SCHDOL

DRAWN BY CTA
DATE 07/2/09

SCALE 3/4"=1'-0"

REV 8-3-10
P.O.#

SECRET 4
6

#27000M CURVED INFINITY DEMO DESK (PUSH BUTTON-MOTORIZED)